

Setting up your Brian K Media email account on your iPhone, iPad, and iPod.

The following information will get your Brian K Media Webmail account setup on your iPhone using an IMAP connection. An IMAP connection allows you to access and manage your email directly from Brian K Media servers. Any changes made on your device will be replicated on the server. Let's take a look at how to set this up:

1. From the home screen on your device tap **Settings**, and then **Mail, Contacts, Calendars**.



2. You'll then tap **Add Account**, Tap **Other** and then **Add Mail Account**.

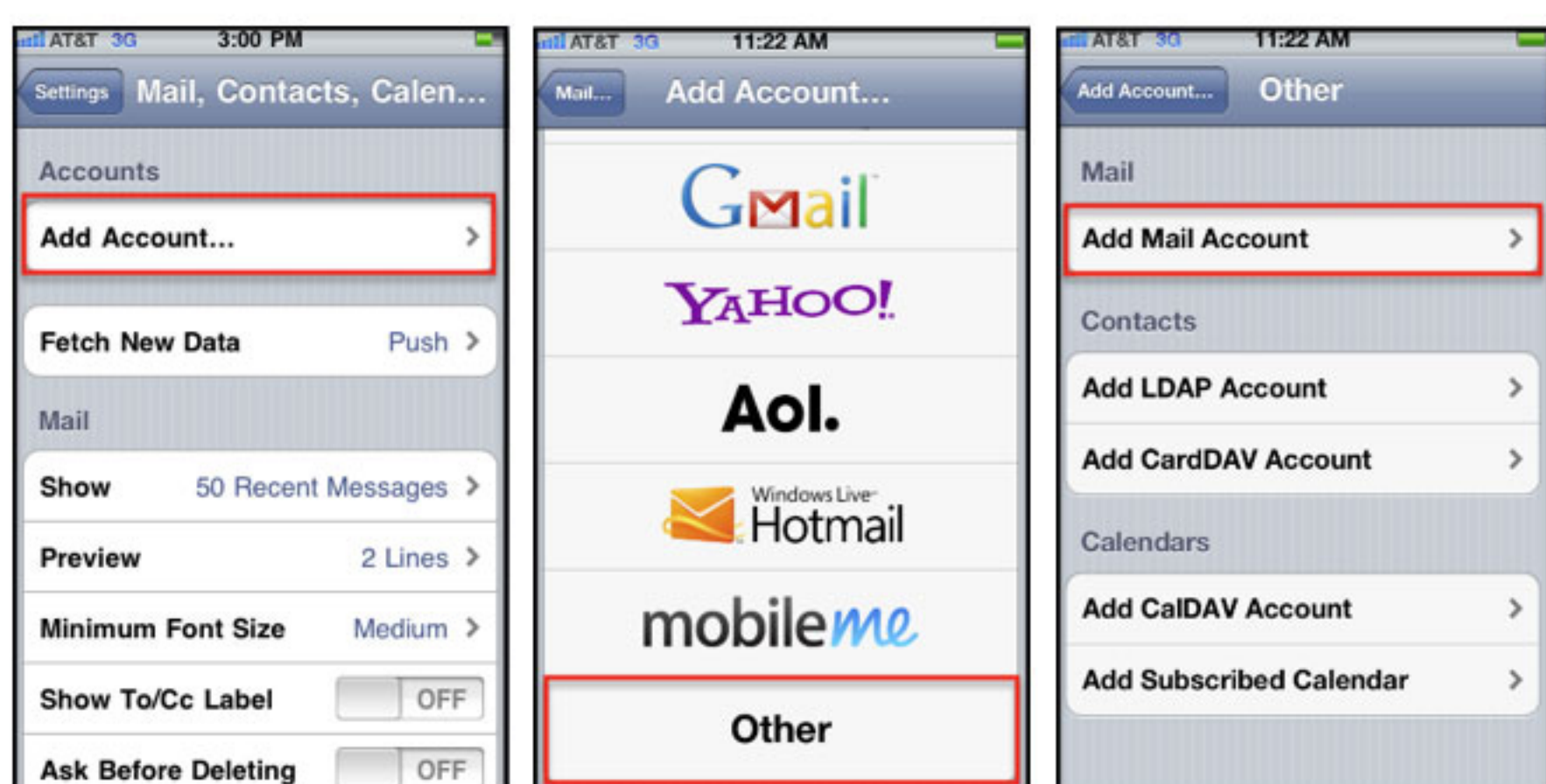

3. The "New Account" screen will appear and you'll then Enter in the following information in the fields provided, and then tap the **Save** button.

- Name - Enter in your first and last name. This is the name that will appear in the **From** field of messages you send.
- Address - Enter your entire email address (e.g., myname@mydomain.com).
- Password - Enter the password for your email account.
- Description - Enter a descriptive name for the account (e.g. Work Account). This description will only be visible to you.

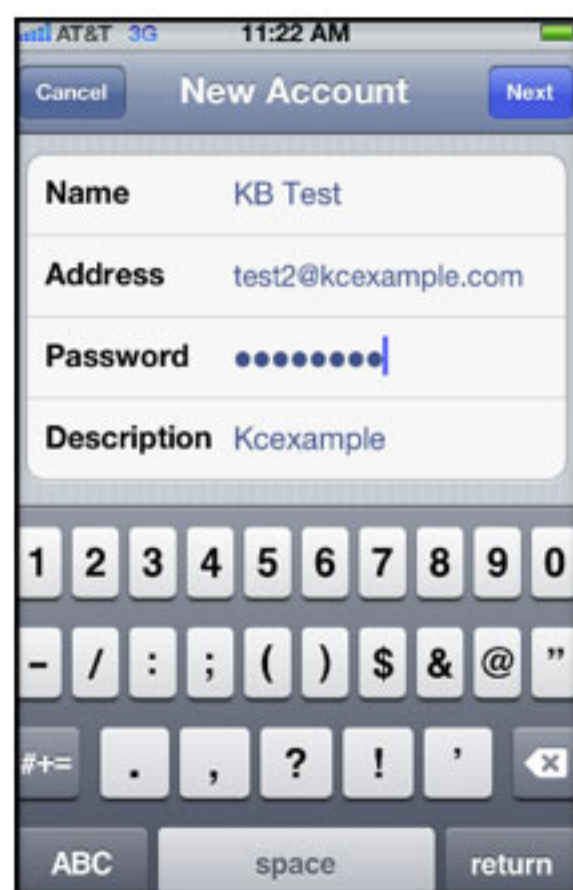

4. After your account has been looked up, you'll then select **IMAP** located at the top and then enter in both the **Incoming Mail Server** and **Outgoing Mail Server** fields with the following information:

- Host Name - Enter in the secure server name: **secure.emailsrvr.com**
- User Name - Enter in your entire email address (e.g., myname@mydomain.com).
- Password - Enter in the password for your email account.

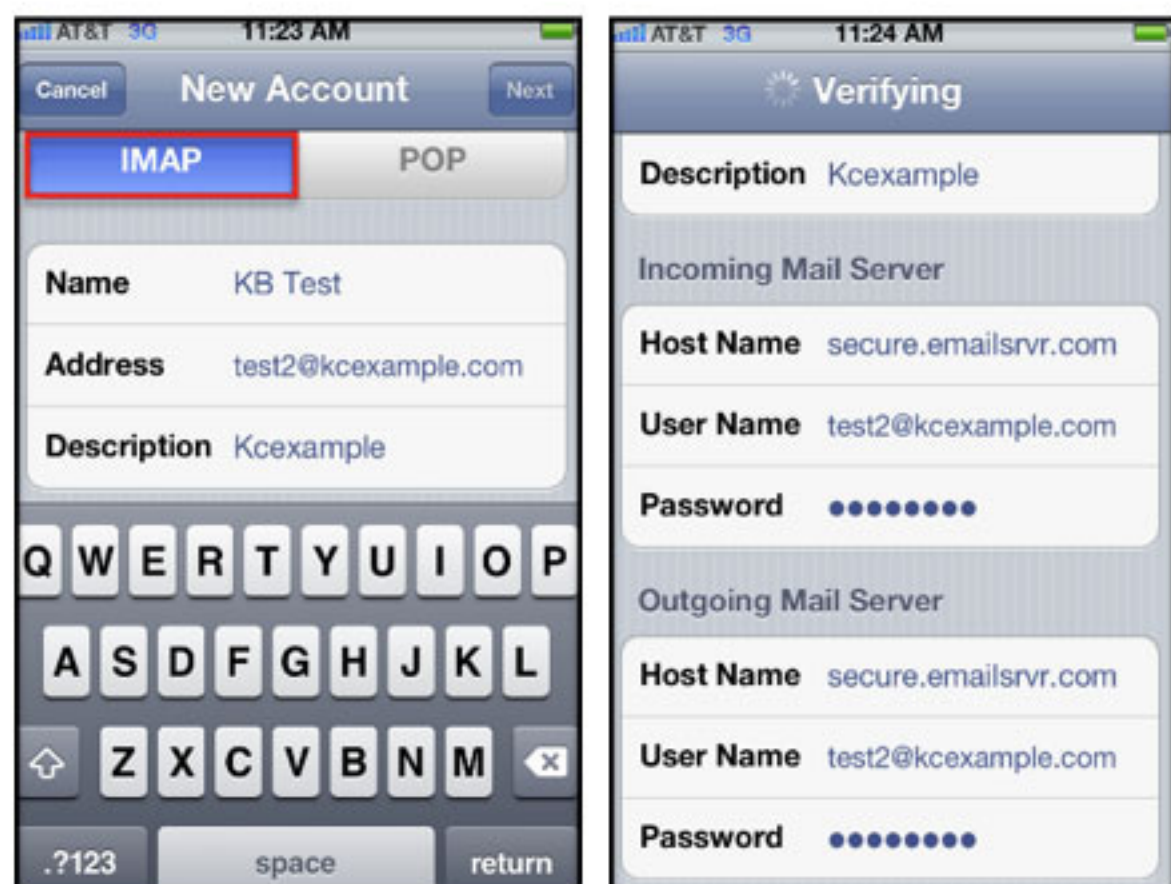

5. After you've entered in all the information, tap **Save** and the device will then verify your settings. After you've been verified, you'll then be take to the **Mail & Notes** screen.

Mapping Your Folders

Mapping your folders allows you to synchronize email across all your devices, email clients and the web. By default, some email clients and mobile devices create their own folders for Sent, Trash, Spam etc. You can map your sent, deleted, and spam messages to their proper folders as will as access any sub-folders you've created by following the procedure below:

1. After you've set up your mail account, go back to your home screen and Tap your **Mail** icon.
2. Select your newly created **Mailbox** and let all your mail synchronize and then go back to your home screen.
3. From the home screen tap **Settings**, **Mail, Contacts, Calendars**, select your **Account**, and then select your **Account** one more time.
4. You'll then tap **Advanced** located at the bottom, tap **Drafts** and on the next screen, select **Drafts** under the **Server** option.

*Note: Repeat step number 4 for your **Sent** and **Trash** folders.*

*Note: You'll see that all your sub-folders have populated under the **Server** option.*